

**PANEL MOUNTING**

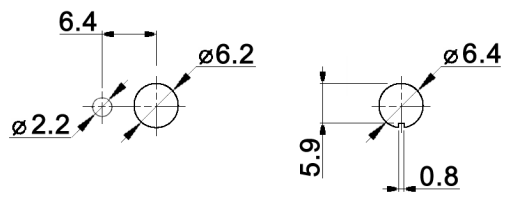

**CONTACT ARRANGEMENT**

code for x	function	connected terminals
N	ON - ON	1-2, 4-5 alternating with 2-3, 5-6
R	ON - MOM	rest position: 1-2, 4-5; pushed down: 2-3, 5-6

**Specifications:**

- Contact rating:** 3A, 250V AC / 6A, 125V AC  
4A, 30V DC / 5A, 12V DC  
6A, 6V DC
- Contact resistance:** 20mOhm max.
- Insulation resistance:** 1 000MOhm min. at 500V DC
- Dielectric strength:** 1 500V, 50Hz for the duration of 1 minute
- Operating temperature:** -45°C to +140°C
- Mechanical life:** 30 000 cycles
- Soldering conditions:** hand-soldering: max.: 420°C, 3sec., 60W  
auto-soldering: max.: 270°C, 5sec.
- Mounting instruction:** max. torque: 49Ncm
- Material:** Terminal: brass, C1020 silver plated  
Case: DAP  
Housing: stainless steel, CNS9265  
Bushing: copper alloy, C3604BD nickel plated  
Actuator: copper alloy, C3604BD chrome plated
- Included accessories:** 2 pcs. nut M6x0.75, nickel plated, 9mm wrench size  
1 pc. tooth washer  
1 pc. locking washer

**Compliance: RohS II (2011/65/EU)**

Tolerances: 0.00: ±0.25mm 0.0: ±0.40mm	Date	Name	<b>MPA 206 x</b>
	06/09	dr	
Contact arrangement	07/15	dr	<b>30 18 30</b>
Dimension	01/11	dr	
Panel mounting	05/10	dr	
Modifications	Date	Name	<b>knitter-switch</b>
			Page
			1/1